



Our COVID Secure App

Helping you to staff safely and keep delivering education to all pupils

Introduction

Each week, our candidates are required to access and update their details on our app showing their availability to work. It is **quick and simple to use**, and also a key element in our ability to provide your school with COVID Secure Staffing.

The App features three different sections:

1

Self-Certification

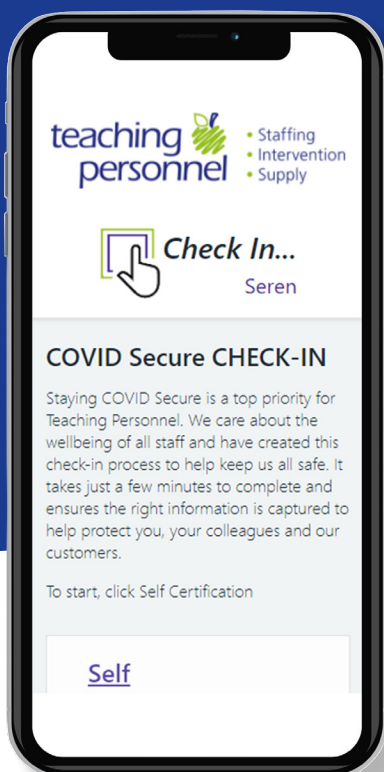

2

Testing

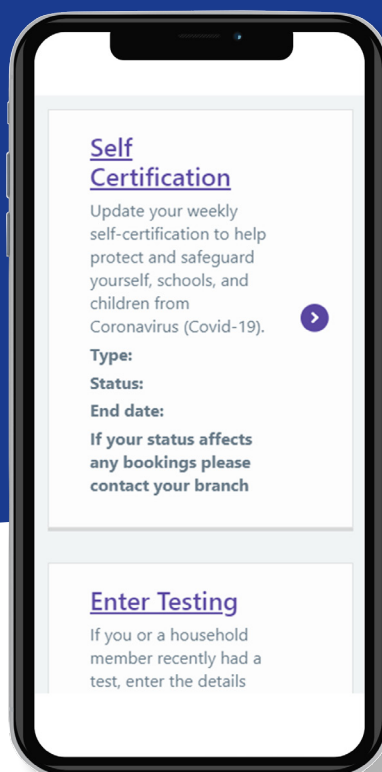

3

Isolation

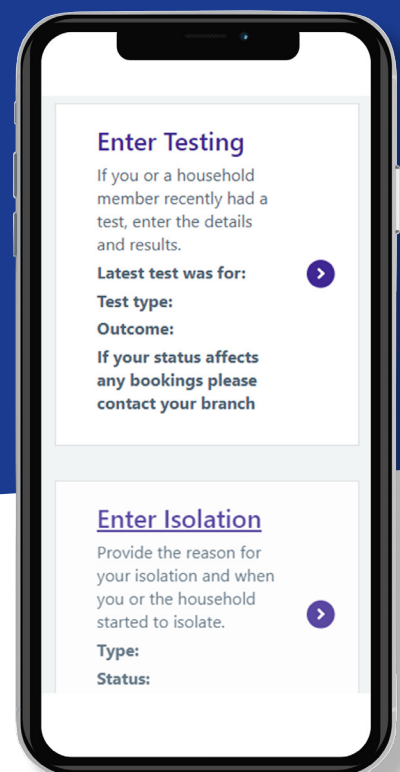

Self-Certification

- Self-Certification must be completed weekly by the candidates to show if they are available to work
- Candidates must confirm that they are not self-isolating or exhibiting symptoms typical of COVID-19. If candidates show symptoms of COVID-19, they will need to record the date when symptoms or self-isolation started
- The answers given are recorded and determine when a candidate is available for work

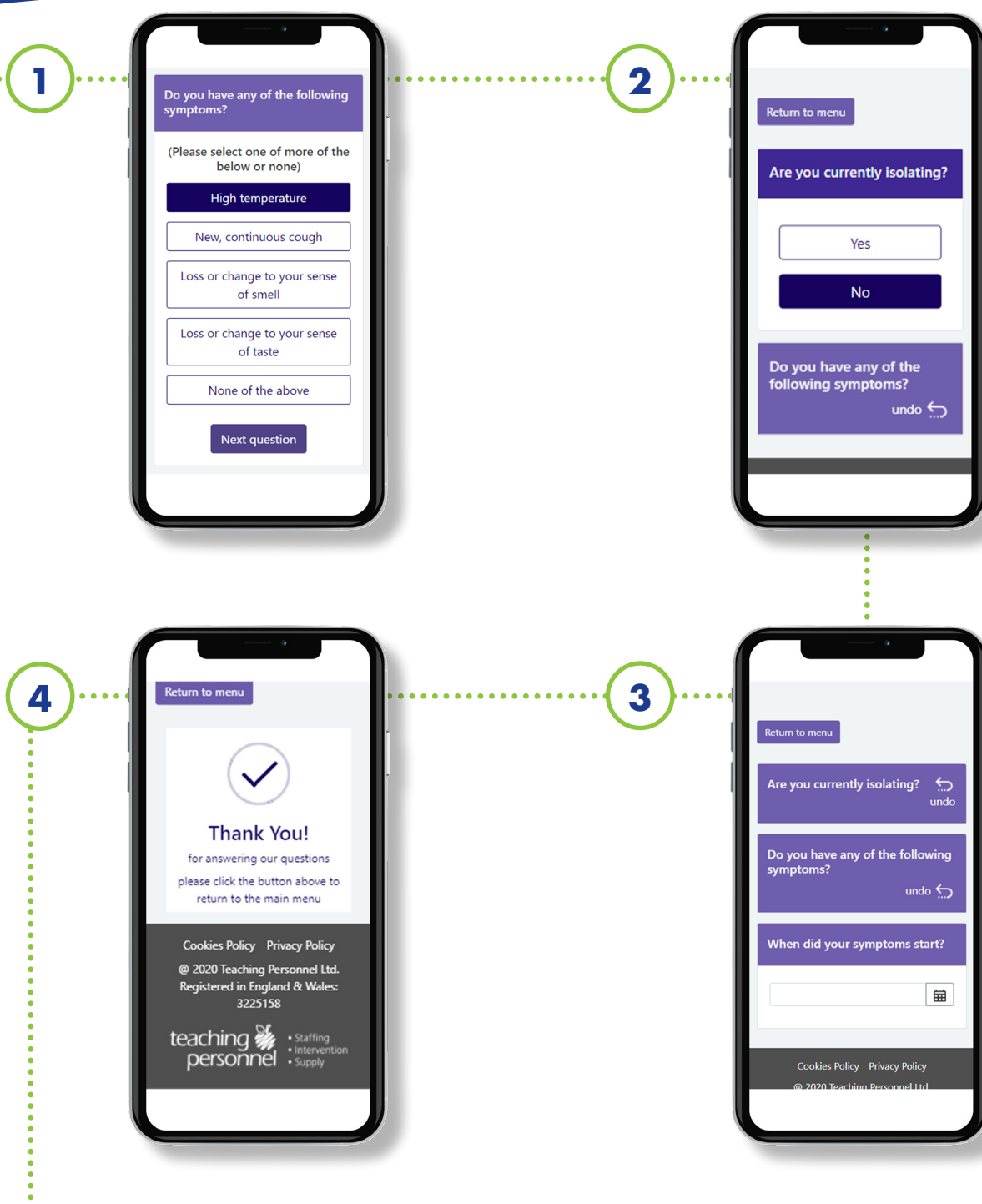

Testing & Self Isolation

- Candidates are prompted to update relevant details of testing and self-isolation
- The reason for and dates of self-isolations are recorded
- The dates, nature and results of COVID-19 testing are recorded

1

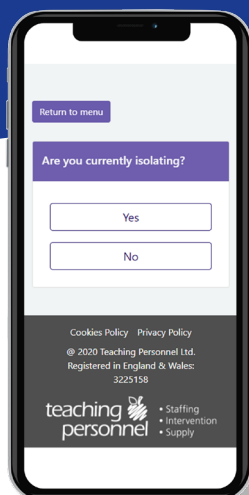

Return to menu

Are you currently isolating?

Yes

No

teaching personnel

• Staffing
• Intervention
• Supply

© 2020 Teaching Personnel Ltd.
Registered in England & Wales:
3225158

2

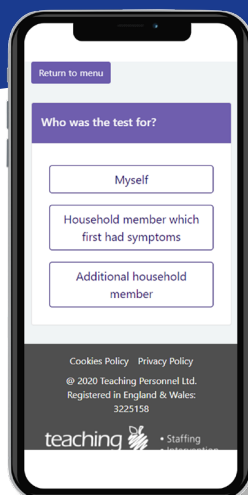

Return to menu

Who was the test for?

Myself

Household member which first had symptoms

Additional household member

teaching personnel

• Staffing
• Intervention
• Supply

© 2020 Teaching Personnel Ltd.
Registered in England & Wales:
3225158

3

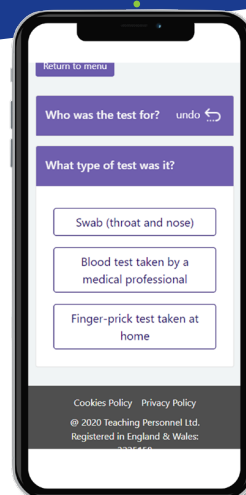

Return to menu

Who was the test for? undo

What type of test was it?

Swab (throat and nose)

Blood test taken by a medical professional

Finger-prick test taken at home

teaching personnel

• Staffing
• Intervention
• Supply

© 2020 Teaching Personnel Ltd.
Registered in England & Wales:
3225158

6

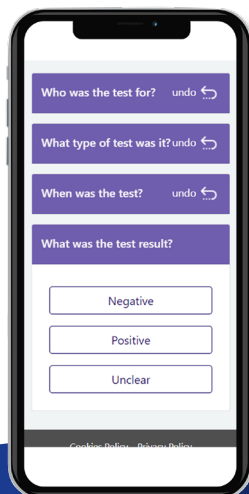

Who was the test for? undo

What type of test was it? undo

When was the test? undo

What was the test result?

Negative

Positive

Unclear

teaching personnel

• Staffing
• Intervention
• Supply

© 2020 Teaching Personnel Ltd.
Registered in England & Wales:
3225158

5

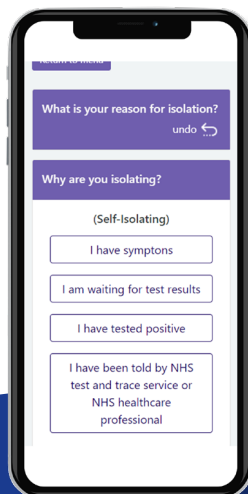

Return to menu

What is your reason for isolation? undo

Why are you isolating?

(Self-Isolating)

I have symptoms

I am waiting for test results

I have tested positive

I have been told by NHS test and trace service or NHS healthcare professional

teaching personnel

• Staffing
• Intervention
• Supply

© 2020 Teaching Personnel Ltd.
Registered in England & Wales:
3225158

4

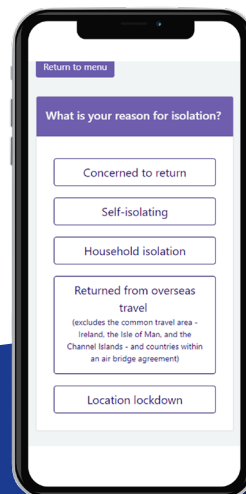

Return to menu

What is your reason for isolation?

Concerned to return

Self-isolating

Household isolation

Returned from overseas travel
(excludes the common travel area - Ireland, the Isle of Man, and the Channel Islands - and countries within an air bridge agreement)

Location lockdown

teaching personnel

• Staffing
• Intervention
• Supply

© 2020 Teaching Personnel Ltd.
Registered in England & Wales:
3225158

Before being placed into a booking, our consultants confirm with the candidate that all the information given is still correct.

Each week we send out links to the latest Government and NHS information regarding symptoms and testing, to ensure that they are kept up to date.

This is just one of the ways in which Teaching Personnel is helping schools stay fully staffed through the pandemic.

We are ready to provide you with safe staffing when ever you require cover. To discuss our available candidates, please contact your local branch or visit www.teachingpersonnel.com/our-branches